

Vista lateral derecha

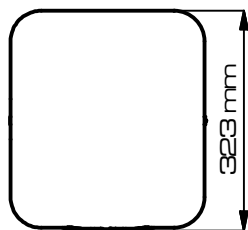

Vista frontal

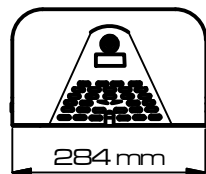

Vista inferior

1- Desenrosque los tornillos laterales para retirar la caja frontal.

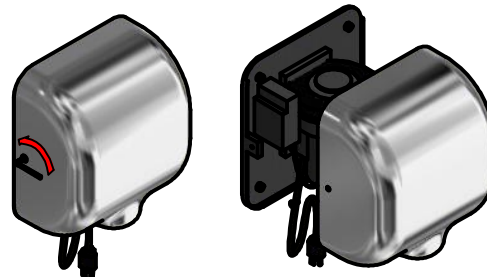

2- Marque los agujeros como lo ilustra la imagen a una altura de 1240 mm.

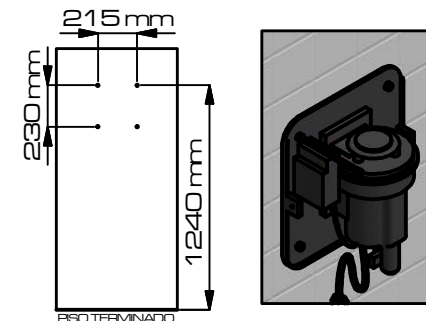

3- Realice las perforaciones.

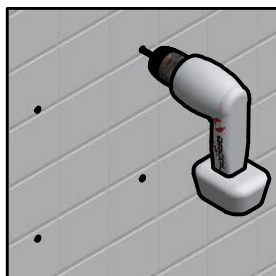

4- Introduzca los chazos.

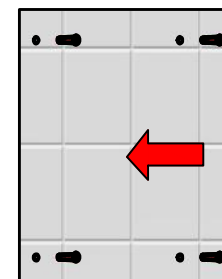

5- Monte el cuerpo a la pared y atornillelo.

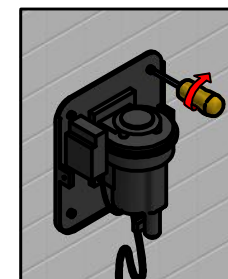

6- Monte la caja frontal.

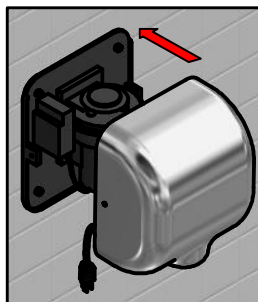

7- Asegure con los tornillos.

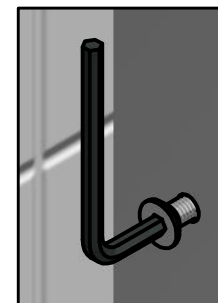

8- Conecte el secador a una fuente eléctrica AC 110V.

